

ADD OPTIONS:

1. Puncture Resistant Protection Fabric
2. Drainage Mat
3. Traffic Coating

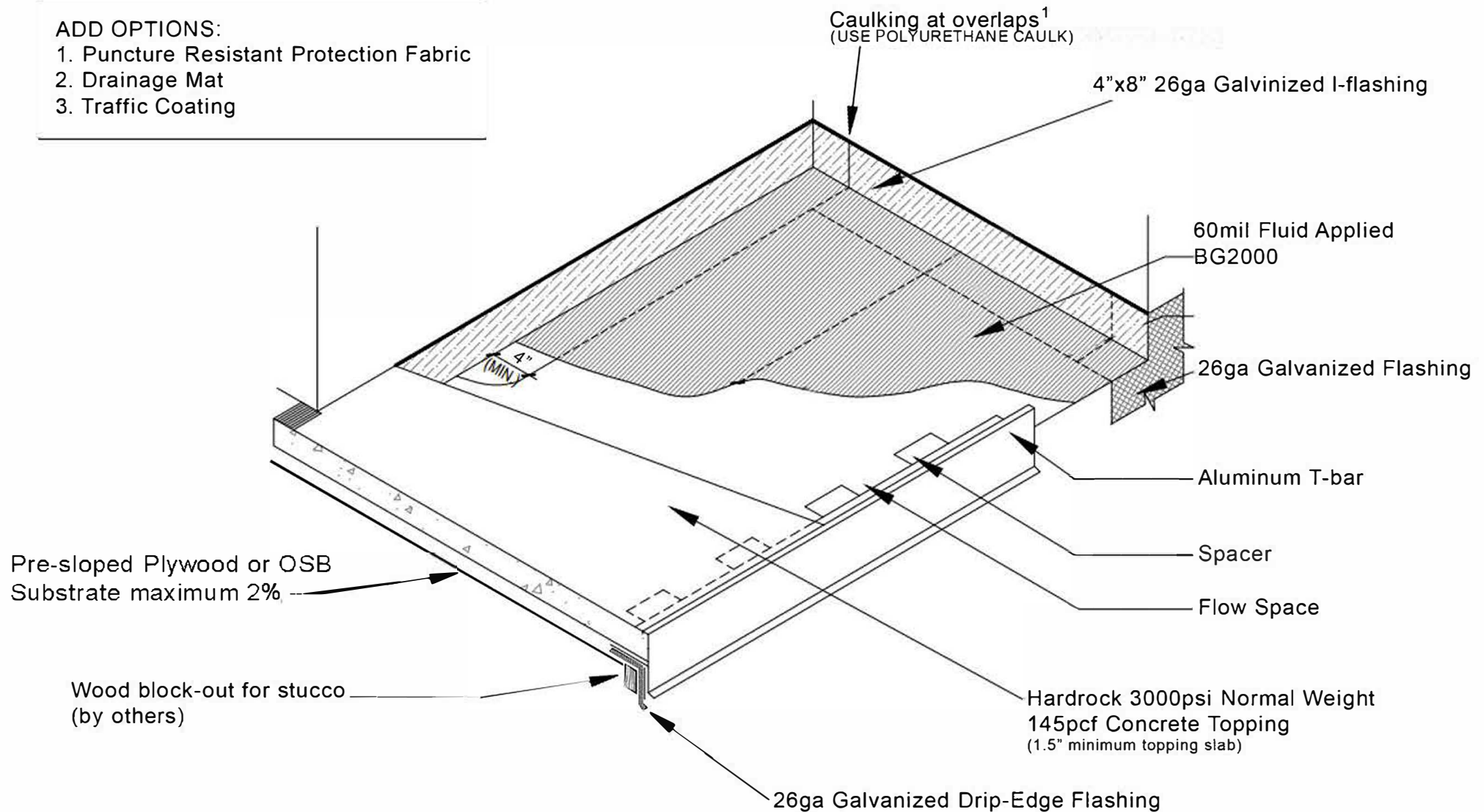

1 - MULTICOAT RECOMMENDS THE USE OF SIKA 1A IN ANY AND ALL JOINTS

TOPPING SLAB UNDERLAYMENT WATERPROOFING DETAILED DRAWING

2021

(949) 888-7100 | MULTICOAT CORPORATION 2021 | WWW.MULTICOAT.COM

